

# PENDOCK

Pendock  
 Halesfield 19, Telford, Shropshire, TF7 4QT.  
 Tel: +44 (0) 1952 580590 Fax: +44 (0) 1952 587805  
 E-mail: technical@pendock.co.uk  
 Web: www.pendock.co.uk

**THIS DRAWING MUST NOT BE SCALED**

© COPYRIGHT TP MANUFACTURING

THIS DRAWING MUST BE REVIEWED IN CONJUNCTION WITH ANY SUPPORTING QUOTATIONS REFERENCED.

THE DESIGN DETAILED IN THIS DRAWING FORMS PART OF A PROPOSED SOLUTION. ALL QUANTITIES AND MEASUREMENTS MUST BE CHECKED IN CONJUNCTION WITH SUPPORTING QUOTATION AGAINST CLIENTS REQUIREMENTS. SPECIFIC CONSIDERATION SHOULD BE GIVEN TO DIMENSIONAL ACCURACY (INCLUDING INT. CLEARANCE) .

PENDOCK SHALL NOT BE LIABLE FOR ANY CLAIM ARISING OUT OF THE USE OF THIS DESIGN IN A SCHEME NOT APPROVED IN WRITING BY PENDOCK.

THIS DRAWING MUST NOT BE LENT OR COPIED, AND THE DESIGN MUST NOT BE COPIED, REPRODUCED OR OTHERWISE USED IN ANY MANNER WITHOUT THE WRITTEN PERMISSION OF PENDOCK. THE CUSTOMER OR ITS CONTRACTOR OR AGENT IS RESPONSIBLE FOR VERIFYING THE ACCURACY AND SUITABILITY OF THE DESIGN IN THIS DRAWING.

PENDOCK STANDARD TERMS AND CONDITIONS, DETAILED ON SUPPORTING QUOTATIONS APPLY.

## NOTES

### Notes :

Tourniquet strappings required to hold column together whilst adhesive is setting.

Ensure column is protected prior to attaching the strap to avoid any damage to surface.

Recommended adhesives for bonding GRP is Everbuild polyuathane 40.

For cutting a metal or down cutting (for worktops) jigsaw blade or a steel cutting disc for grinders is advised.

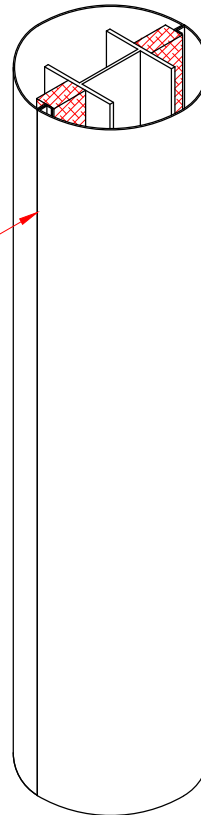

Column halves installed perpendicular and concentric to each.

REV	DATE	BY	APP
-----	------	----	-----

GENERAL INFORMATION  
 ALL DIMENSIONS IN MM  
 UNLESS OTHERWISE STATED



THIRD ANGLE PROJECTION

DATE	DRAWN	CHECKED	APPROVED
------	-------	---------	----------

CLIENT/PROJECT

Circular  
 GRP Column

PROJECT DETAILS

Encasement  
 Pendock Column

SCALE nts	SHEET 3 of 3	A4
-----------	--------------	----

DWG No.	REV
---------	-----

Installation Guide —